

State of New York.

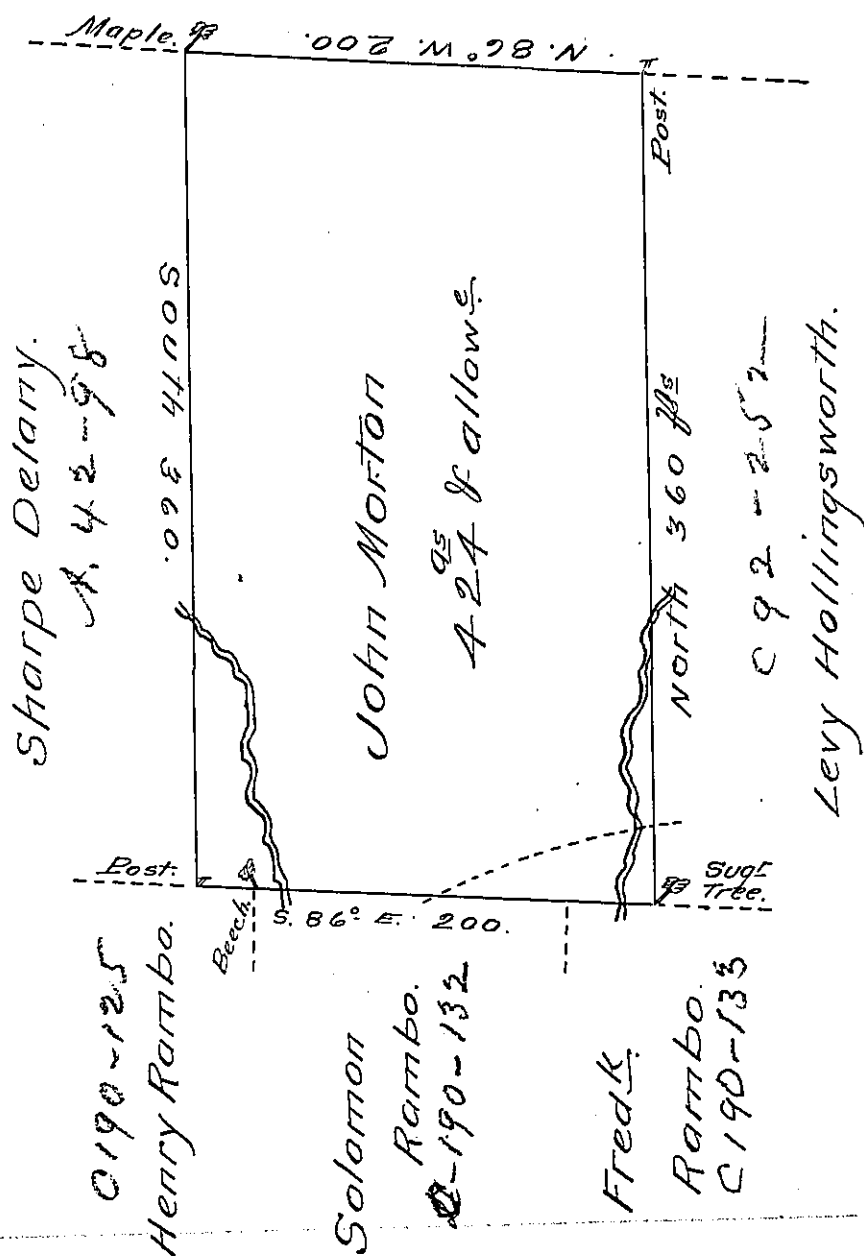

A Draught of a tract of land Called _____
 Situate Joining the York line and land Surveyed for
 Levy Hollingsworth & others in Northumberland County
 Containing four Hundred & twenty four acres & al-
 lowance of Six & Cent for roads &c. Surveyed for John
 Morton the 6th. Day of Sept^r. 1784 in Pursuance of
 a warrant Dated the 2^d. Day of July 1784.

To John Lukens Esq^r.
 Surv^r. Gen^l. }

by W^m. Gray D.S.

IN TESTIMONY that the above is a copy of the original remaining on file in
 the Department of Internal Affairs of Pennsylvania, made
 conformably to an Act of Assembly approved the 16th day of
 February, 1833, I have hereunto set my Hand and caused
 the Seal of said Department to be affixed at Harrisburg,
 this Twenty sixth day of February 1908.

Henry Howard

Secretary of Internal Affairs.